

## Lead-Acid Battery Charger



### Features

- Lead-Acid Battery Charger
- Constant Power Charging Mode
- Battery Polarity Reverse Protection
- 2 LED Charging Indicator
- 2 Step Fast Charging Capability
- Protections:
  - Short circuit / Over voltage / Over current
  - Over temperature
- MTBF > 50,000 hours
- Recommend for 24V/55~90Ah Lead-Acid Battery

### EA1230B - PP

PP: DC plug type

### General Specification

#### OUTPUT

MODEL NO.	FAST CHARGE CURRENT	MAINTAINING CHARGE VOLTAGE	FLOATING CHARGE VOLTAGE
EA1230B	8A	29.4V	27.5V

#### NOTE:

- 1 : Ripple & Noise is measured by using 20MHz bandwidth limited oscilloscope and terminated each output with a 0.1uF ceramic capacitor & parallel with 47uF aluminum capacitor at full load and nominal line.
- 2 : Line regulation is defined by changing  $\pm 10\%$  of input voltage from nominal line at rated load.
- 3 : Max. Power (W)  $\geq V_o \times I_o$

#### INPUT

- Input Range: 100 to 240 VAC
- Frequency: 50 to 60Hz
- Input Current: 6A Max.
- Inrush Current:  $\leq 220A/230VAC$
- Hold Up Time:  $\geq 8.3ms$
- Turn On Time:  $\leq 3s$

#### PROTECTION

- Short Circuit Protection: Auto Recovery
- Over Voltage Protection: Auto Recovery
- Over Current Protection: Auto Recovery
- Over Temperature Protection: Auto Recovery

#### ENVIRONMENT

- Operating Temperature: -20 to 40°C
- Storage Temperature: -20 to 85°C
- Operating Humidity: 10% to 90%
- Storage Humidity: 5% to 95%

#### MECHANICAL

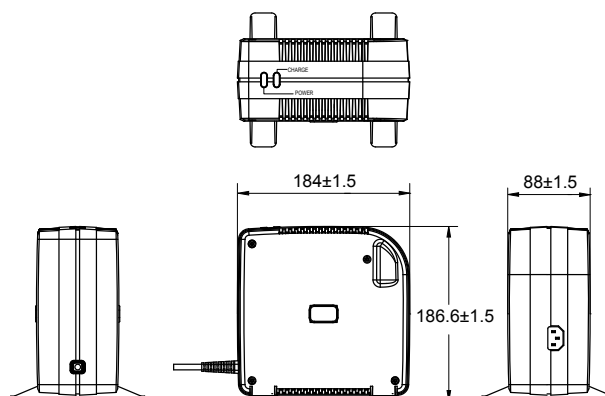

- Case Size: 184L x 88W x 186.6H (mm)
- AC Inlet: C14
- DC Cable: SVT

#### SAFETY

- Certified for whole series: UL/cUL 1012, EN/IEC 60335-1/EN IEC 60335-2-29
- Complied with CE, FCC