

Medical AC/DC Wall Mount Adaptor

Vertical (USB & SR Type)



Horizontal (USB & SR Type)



Features

- 2 x MOPP Compliance, IEC/EN60601-1 Approval
- Protections:
Short circuit / Over voltage / Over current
- Energy Efficiency Level VI
- No Load Power Consumption $\leq 0.1W$
- MTBF > 100,000 hours

EM1005 X Y Z T - vv PP

- X:** Output range
- Y:** Case type: (V)Vertical or (H)Horizontal
- Z:** AC plug type: • U: USA • E: EU • K: UK
- T:** Output type: U (USB) or S (SR)
- vv:** Specified output voltage, i.e. 12 is 12VDC
- PP:** DC plug type, i.e. Code 01 for 5.5x2.1mm or other options (refer to the appendix page)

General Specification

OUTPUT

MODEL No.	MAX. OUTPUT POWER (W)	OUTPUT VOLTAGE (Vo)	MIN. LOAD (Io)	MAX. LOAD (Io)	LOAD REGULATION	LINE REGULATION	RIPPLE & NOISE
EM1005AYZT	6W	5~8V	0A	1.2A	$\pm 5\%$	$\pm 1\%$	100mV
EM1005BYZT	6W	9~12V	0A	0.66A	$\pm 5\%$	$\pm 1\%$	180mV
EM1005CYZT	4.5W	9V	0A	0.5A	$\pm 5\%$	$\pm 1\%$	180mV
EM1005DYZT	6W	9V	0A	0.67A	$\pm 5\%$	$\pm 1\%$	180mV

NOTE:

- 1 : Ripple & Noise is measured by using 20MHz bandwidth limited oscilloscope and terminated each output with a 0.1uF ceramic capacitor & parallel with 47uF aluminum capacitor at full load and nominal line.
- 2 : Line regulation is defined by changing $\pm 10\%$ of input voltage from nominal line at rated load.
- 3 : Max. Power (W) $\geq V_o \times I_o$

INPUT

- Input Range: 100 to 240 VAC
- Frequency: 50 to 60Hz
- Input Current: $\leq 0.6A$
- Inrush Current: $\leq 60A/230VAC$
- Hold Up Time: $\geq 8.3ms$
- Turn On Time: $\leq 5s$

PROTECTION

- Short Circuit Protection: Auto Recovery
- Over Voltage Protection: Auto Recovery
- Over Current Protection: Auto Recovery

ENVIRONMENT

- Operating Temperature: -20 to 40°C
- Storage Temperature: -20 to 85°C
- Operating Humidity: 10% to 90%
- Storage Humidity: 5% to 95%

SAFETY

- Certified for whole series: ANSI/AAMI ES60601-1, CAN/CSA-C22.2 No. 60601-1, TUV EN 60601-1, CB IEC 60601-1, CE EMC(EN 60601-1-2) UL 62368-1, CAN/CSA C22.2 No. 62368-1, TUV EN 62368-1, CB IEC 62368-1, FCC Part 15B, CE EMC(EN 55032+EN 55035), CCC, BSMI, UKCA
- Certified for assigned models: PSE

MECHANICAL

Horizontal (USB & SR Types)

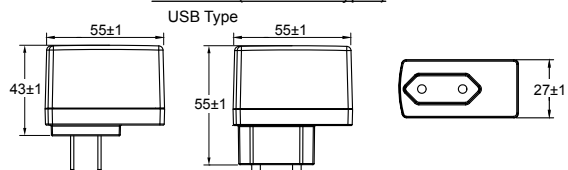

Vertical (USB & SR Types)

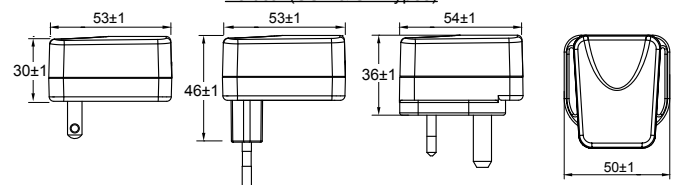

- Case Size: Horizontal: USB: 55L x 27W x 55H (mm)
SR: 55L x 25W x 55H (mm)
Vertical: USA: 53L x 41W x 30H (mm)
EU: 53L x 41W x 46H (mm)
UK: 54L x 50W x 36H (mm)
- AC Plug: U: USA, E: EU, K: UK
- Weight: 70g